

AV series

DN 10–40

This range of high-quality solenoid valves is not dependent on a specific minimum differential pressure; the valves operate extremely reliably with no pressure, at slight differential pressure, right through to maximum pressure. They are therefore the valves of choice for installation in plants where differential pressures fluctuate

greatly and are not possible to determine precisely in advance. Solenoid valves of the AV series are approved as **safety shut-off devices according to DIN EN 264 (Registration No. 5S235/2000)** and are particularly suitable for use as anti-siphon valves in supply installations for light fuel oil EL.

Dimensioned drawings

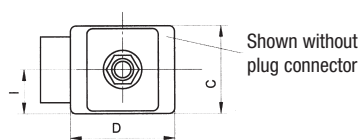
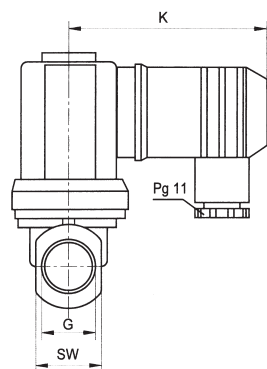
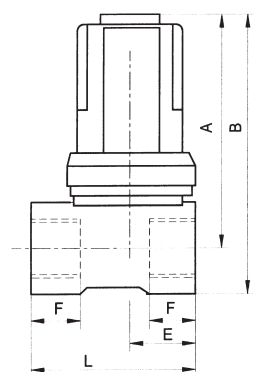

Technical data

Type

2/2-way

Operating mode

normally closed

Type of construction

Diaphragm solenoid valve, coupled. No initial pressure needed.

Pressure range

-0.9 to 4 bar (DN 10, 13), -0.9 to 10 bar (DN 20-40)

No back-pressure may occur as the valve will open in an uncontrolled manner.

Materials

Casing: brass, internal parts: stainless steel

Sealing material

FPM (Viton)

Mounting position

Any, solenoid system preferably upright

Temperature of medium

0°C to +90°C

Max. ambient temperature

55°C

Duty cycle

100% ED

Electrical connection

Device socket to DIN 43 650

Voltage / current type

Standard version 230 V, 50 Hz

Special voltages available

Voltage	Code
110 VAC	2
24 VAC	8
24 VDC	6

Degree of protection

IP 65 according to DIN 40 050 with device socket

Power consumption in VA or W

Switching state	Nominal diameter/DN					mm
	10	13	20	25	40	
AC: Start	34	36	38	160	202	VA
AC: Oper.	14	14	14	38	38	VA
DC: Start						
+ Operation	10	10	10	-	-	W

Product Summary

DN (mm)	Pressure range (bar)	k_{vs} value (m ³ /h)	Connection thread	Weight (kg)	Type
10	-0.9 – 4	1.8	G 3/8"	0.4	AV102MS2
13	-0.9 – 4	3.5	G 1/2"	0.55	AV131MS2
20	-0.9 – 10	8.6	G 3/4"	1.0	AV201MS2
25	-0.9 – 10	11.0	G 1"	1.7	AV251MS2
25	-0.9 – 10	11.0	G 1 1/4"	1.7	AV252MS2
40	-0.9 – 10	30.0	G 1 1/2"	3.5	AV401MS2
40	-0.9 – 10	30.0	G 2"	3.5	AV402MS2

DN	A	B	C	D	E	F	G	K	L	M	SW
10	72	86	38	38	20	12	G 3/8"	65	50	3.5	27
13	83	99	45	51	24	14	G 1/2"	65	58	3.5	32
20	99	119	66	66	35	16	G 3/4"	65	80	3.5	41
25	145	166	105	105	69	18	G 1"	69	95	7	41
25	145	166	105	105	69	18	G 1 1/4"	69	95	7	50
40	157	187	105	105	69	22	G 1 1/2"	69	132	7	60
40	157	187	105	105	69	22	G 2"	69	132	7	70